

A P R I L 2 6 , 1 9 8 5



The Dedication Of

FOELLINGER  
AUDITORIUM

University of Illinois at Urbana-Champaign

---





FOELLINGER AUDITORIUM

---

Dedicated In Recognition Of  
Helene R. Foellinger  
Class of 1932

Dedication Ceremonies  
Midday • Friday • April 26 • 1985  
On The Quad  
Urbana

PRESIDING

Thomas E. Everhart  
Chancellor  
University of Illinois at Urbana-Champaign

REMARKS

Alan M. Hallene  
President  
University of Illinois Foundation

Walker C. Johnson  
Architect-Project Manager  
Holabird & Root

E. David Edquist  
President  
Student Government Association

Nina T. Shepherd  
President  
University of Illinois Board of Trustees

Stanley O. Ikenberry  
President  
University of Illinois

Helene R. Foellinger  
Retired Publisher  
*Fort Wayne News-Sentinel*





**R**estoration and renovation of the Auditorium on the Quadrangle of the University of Illinois at Urbana-Champaign has been realized by the generous gift of honor student, campus leader and distinguished alumna Helene R. Foellinger.

Helene Foellinger has played a prominent role in the history of the University of Illinois, as both a visionary benefactor and, earlier, as an active student leader. A mathematics major in the College of Liberal Arts and Sciences, Miss Foellinger was an influential personality within the campus community of her time. A partial list of honors she was awarded and activities she participated in during her undergraduate years includes membership in Phi Beta Kappa, Pi Beta Phi, Phi Mu Epsilon, Alpha Lambda Delta; and service with the student council, Mortar Board and Torch. She also was an editor for the *Daily*

*Illini* and played on the tennis team.

Upon completion of her degree in 1932, Miss Foellinger returned to Fort Wayne, Indiana, as a reporter for the *News-Sentinel*. After the death of her father, Oscar G. Foellinger, in 1936, she succeeded him as president and general manager of the News Publishing Company and later became president of the News-Sentinel Broadcasting Company, Inc., and Fort Wayne Newspapers, Inc., a joint venture with the city's *Journal-Gazette*. In 1974, Miss Foellinger was featured in *Parade Magazine* as one of ten American businesswomen distinguished for their service on corporate boards.

Since 1977, Helene Foellinger has been a director of the University of Illinois Foundation; and in 1979, she began service on the Illinois Cabinet, the national governing board for the Campaign for Illinois.



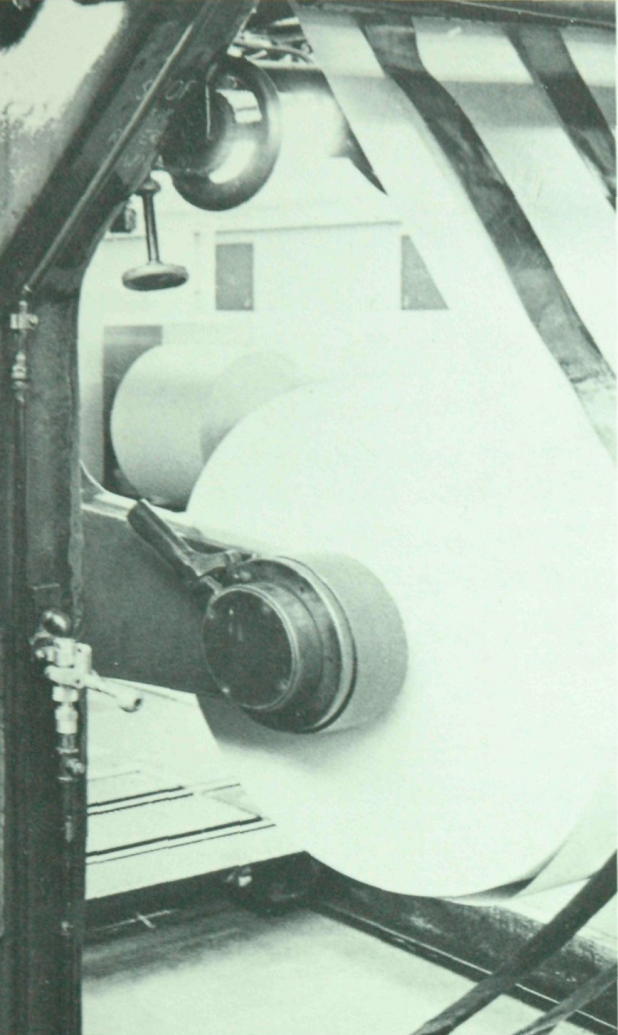

*Restoration and renovation of the Auditorium on the Quadrangle of the University of Illinois at Urbana-Champaign has been realized by the generous gift of honor student, campus leader and distinguished alumna Helene R. Foellinger.*



In that capacity, she helped preside over the most successful private fundraising drive in the University's history.

**I**n addition to her support for the renewal of the historically important Auditorium building, Miss Foellinger's generosity supported the Illinois Endowment for the Performing Arts. Foellinger Great Hall in the Krannert Center for the Performing Arts was named to recognize her gift and honor the memory of her late sister and 1936 Illinois alumna, Loretta Foellinger Teeple.

Throughout her professional and personal life, Helene R. Foellinger has been active in the enrichment and strengthening of education and her alma mater. She has devotedly served the University of Illinois family as advisor, benefactor, friend.

*From the  
1932 ILLIO.*

*Publisher Helene R.  
Foellinger in the  
pressroom of the  
News-Sentinel.*



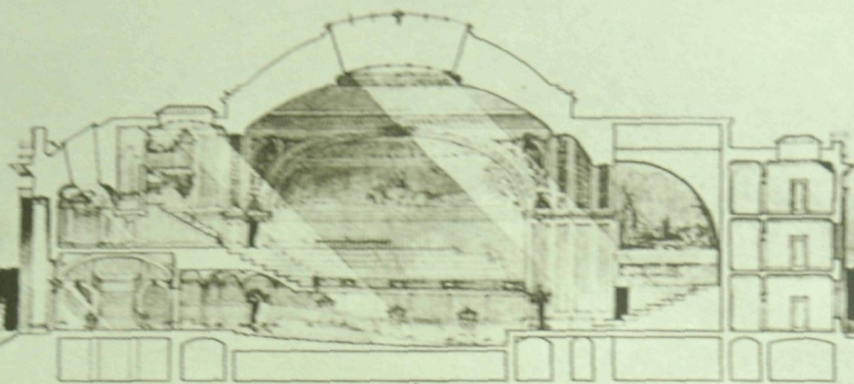

**T**he Auditorium has played a major role in the University's history for more than three quarters of a century. Early planners of the University's development envisioned a structure that would serve as a southern boundary to the Quad-rangle while providing a focal point around which the campus's future growth could be established.

Clarence Howard Blackall (Class of 1877), creator of the Bowdoin Theatre in Boston, one of the Urbana campus's planners, and architect of the Auditorium said: "Our University of Illinois will focus about the Auditorium. This building is located upon the only commanding site of the entire grounds, at the crest of the slight rise towards the south from Green Street, where it

*Longitudinal section drawing of the proposed Illinois Auditorium, 1906.*

*Rendering of the Auditorium as originally proposed.*

will form the center of the growth for many years to come, so that ultimately this structure which now seems in a way far to the south will be surrounded on all sides by large and developed schools."

A number of possible uses for such a building were discussed, and in 1905 the University Board of Trustees approved plans to construct a multipurpose facility for concerts, lectures, and other events.





**A** Most immediately budgetary problems arose. The State Legislature decided to allocate only half of the \$200,000 the University had requested for the project, a determination which profoundly affected the proposed design and construction. Blackall received the news of the reduced funding with great disappointment. He had conceived of a comprehensive structure for musical performances which would include a backstage area. Instead, he was forced to build a "temporary" wall where the backstage area was to have been and to abandon plans for a south wing of the building intended to house the School of Music.

*Construction  
underway about 1906.*

*Auditorium architect  
C.H. Blackall,  
graduate of the U of I  
class of 1877.*



1 9 0 7

*"We are assembled here not merely to celebrate the opening of this building for University uses in general, but to dedicate it formally to the service of one of the most important elements of our University life and one of the greatest of the fine arts — music." President James at dedication ceremonies in 1907. Photo date and musical group unknown.*

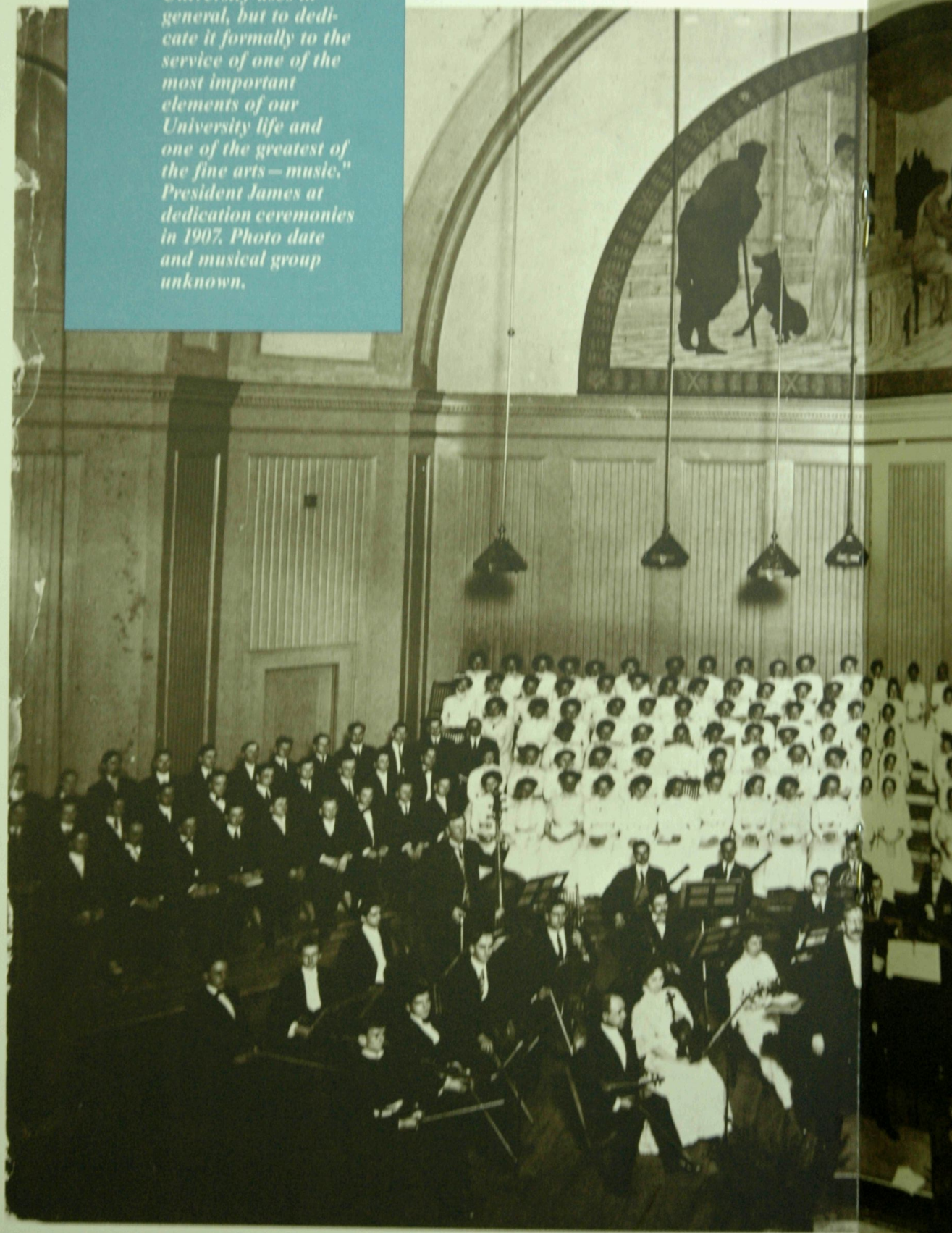







here not merely to celebrate the opening of this building for University uses in general, but to dedicate it formally to the service of one of the most important elements of our University life and one of the greatest of the fine arts—music.” President James at dedication ceremonies in 1907. Photo date and musical group unknown.







On November 4 and 5 of 1907, the scaled-down facility was dedicated with an inaugural ceremony and a two-day series of concerts. The program featured the work of composer Edward Alexander MacDowell, whose piano music helped establish an independent American musical style. During those concerts, a major acoustical problem was detected. A flaw in the building's construction caused a now legendary echo, which reverberated throughout the building and up into the dome. Remodeling efforts in 1915 and 1937 sought to solve the acoustical horrors and achieved some success.

Though failing to realize the full scope of the architect's concept, the Auditorium was still an impressive achievement. During the dedication ceremony, University President Edmund J. James said of it:

"Thousands of students may gather here where now there are only hundreds. The taste of a growing and refining people may demand a reconstruction of many of our buildings. Certainly another and larger hall will be demanded for many common purposes; but I cannot conceive of a time when the simple and noble lines of this structure will ever cease to be a delight to our successors."





*Photographed from University Hall, where the Illini Union now stands.*





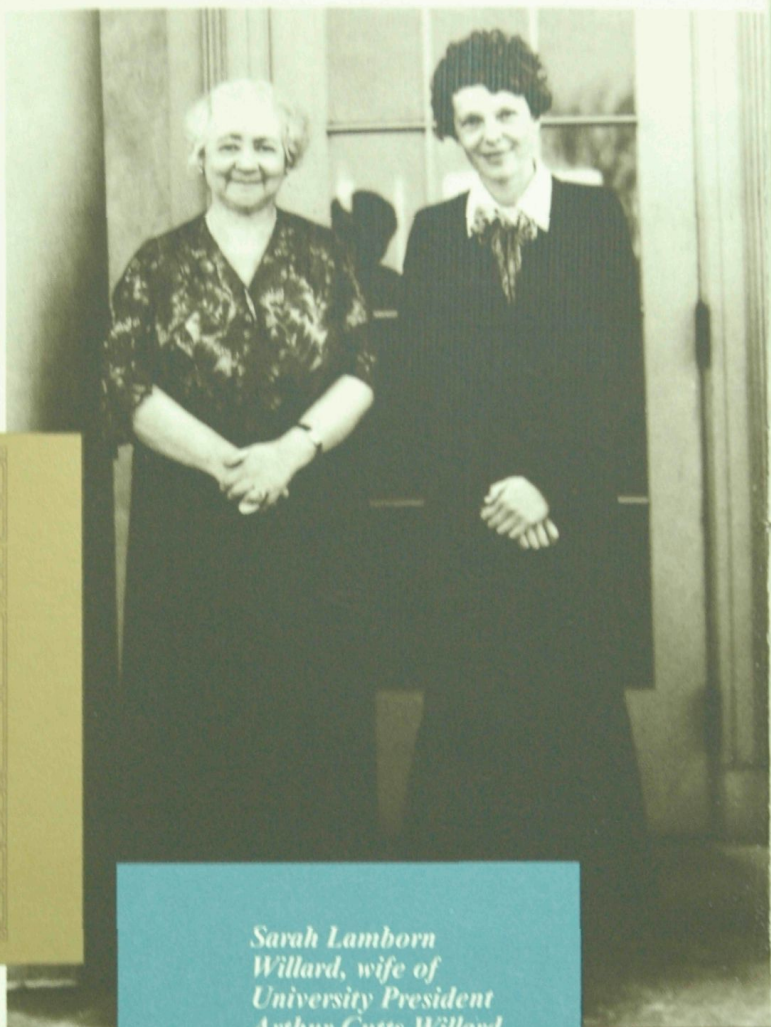
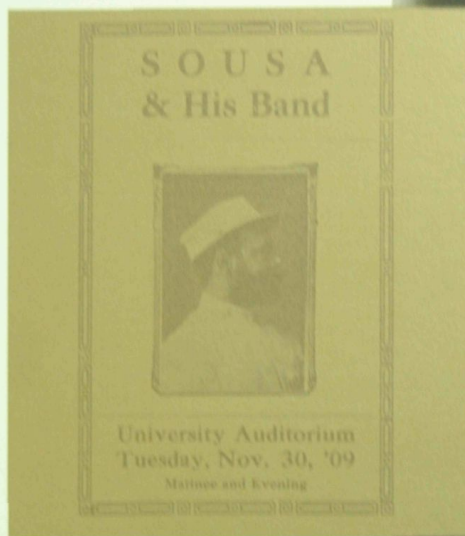

*Sarah Lamborn Willard, wife of University President Arthur Cutts Willard and aviator Amelia Earhart, first woman to fly the Atlantic Ocean.*

*Concert programs from 1909 and 1924.*

*Twilight band concert, circa 1912.*

**P**robably no other building on the campus of the University of Illinois can claim a greater distinction as a cultural and entertainment center than the Auditorium. Since 1907 it has stood as the architectural embodiment of the unique purpose it has served for the campus. Throughout its history, the Auditorium's doors have opened to great musicians like Marian Anderson and Artur Rubinstein, to political figures, orators, educators, scientists and poets including Eleanor Roosevelt, Thomas Dewey, Eve Curie, Louis Leakey and Robert Frost.

Activities conducted in the Auditorium over the years include: University band and orchestra concerts, YMCA lectures, Commencement, plays, dramatic readings, teachers' institutes, patriotic meetings during World War I, inter-varsity debates, memorial services, convocations, President's receptions,

University Forum and MillerComm lectures, movies, placement tests, final exams, lecture courses, organ recitals, stunt shows, art exhibits, Baccalaureate addresses, and Star Course offerings ranging from soloists to speakers to symphonies.

An historic building usually derives its significance from its associations with only one person—a famous person who either lived in it or built it. The Auditorium, however, has had associations with not one, but hundreds of famous people.





**JASCHA HEIFETZ**  
VIOLINIST

Management: WOLFSON MUSICAL BUREAU  
290 West 57th Street, New York  
The Business Phone Unit

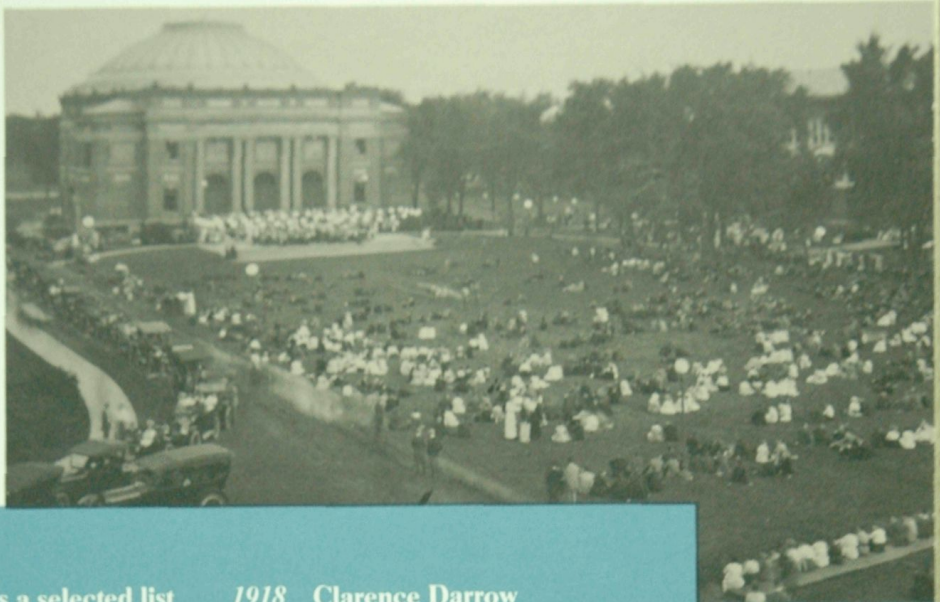

UNIVERSITY AUDITORIUM **FEB. 12**  
Transfer Existing at 3:30  
Prices: \$1.00, \$2.50, \$2.00  
Tickets only at Union, Main-Over, Swansell, Leslie's  
Mail orders sent to Business Office, University

Following is a selected list of Star Course performers followed by a list of speakers who have had engagements in the Auditorium.

- |                  |                              |      |                            |
|------------------|------------------------------|------|----------------------------|
| 1909             | John Phillip Sousa           | 1918 | Clarence Darrow            |
| 1916             | Admiral Robert Peary         | 1919 | General Leonard Wood       |
| 1918             | Pablo Casals                 | 1921 | Sinclair Lewis             |
| 1919             | Efrem Zimbalist              | 1923 | Vachel Lindsay             |
| 1924             | Jascha Heifetz               | 1925 | Carl Van Doren             |
|                  | Sergei Rachmaninoff          | 1926 | Robert Frost               |
| 1925             | Paul Whiteman                | 1929 | Carl Sandburg              |
| 1931             | Admiral Richard Byrd         | 1933 | Senator George Norris      |
| 1940             | Ezio Pinza                   | 1935 | Amelia Earhart             |
|                  | Artur Rubinstein             | 1939 | Thomas E. Dewey            |
| 1941             | Marian Anderson              | 1940 | Eve Curie                  |
| 1943             | Helen Traubel                | 1942 | Margaret Bourke-White      |
| 1946             | Rudolf Serkin                | 1944 | Drew Pearson               |
| 1948             | Duke Ellington               |      | Norman Thomas              |
|                  | Fred Waring                  | 1949 | Alexander Korensky         |
| 1949             | Igor Stravinsky              | 1949 | Countess Alexandra Tolstoy |
|                  | Burl Ives                    |      | Ralph J. Bunche            |
| 1950             | Royal Philharmonic Orchestra | 1950 | Walter Reuther             |
| 1953             | Charles Laughton             |      | Dr. Julian Huxley          |
| 1954             | Vaughn Monroe                | 1952 | Bennett Cerf               |
|                  | Richard Tucker               | 1954 | Clifton Fadiman            |
| 1955             | Claude Rains                 | 1955 | John Dos Passos            |
| 1956             | Dave Brubeck                 |      | Ogden Nash                 |
| 1958             | Jose Greco                   | 1956 | Eleanor Roosevelt          |
| 1960             | Hal Holbrook                 | 1958 | Mark Van Doren             |
| 1961             | Ravi Shankar                 | 1959 | Wernher Von Braun          |
| 1962             | Helen Hayes                  |      | Senator J. W. Fulbright    |
|                  | Joan Baez                    | 1962 | Henry Steele Commager      |
| 1966             | Carlos Montoya               | 1963 | Harrison Salisbury         |
| 1968             | Saul Bellow                  | 1964 | Bruce Catton               |
|                  |                              | 1965 | Vance Packard              |
| <b>LECTURERS</b> |                              |      | Dr. Louis Leakey           |
| 1915             | Jane Addams                  | 1967 | Constantin Doxiadis        |
|                  | Lorado Taft                  |      | John K. Galbraith          |
|                  |                              |      | Dick Gregory               |
|                  |                              | 1968 | Dr. Eric Fromm             |
|                  |                              |      | Pierre Salinger            |
|                  |                              |      | Julian Bond                |
|                  |                              | 1969 | Lawrence Ferlinghetti      |
|                  |                              | 1970 | Adlai Stevenson III        |
|                  |                              | 1971 | Stanley Kramer             |
|                  |                              | 1974 | R. Buckminster Fuller      |





*Aerial view of 1985 renewal showing new backstage and forecourt additions.*

*Nearing completion of the interior, April 1985.*



**R**edicated April 26, 1985, as Foellinger Auditorium, a new chapter in the building's history has begun. Miss Foellinger's gift has allowed the University to fulfill the aspirations of many as first expressed by the original architect:

"This building should in time be a focus for the historic interests of the University, no less than for its academic life."

Improvement of the exterior has included replacement of the deteriorating painted metal dome with a new copper roof, construction of a 6000-square foot backstage area, tuckpointing, new lighting around the perimeter of the dome and along the dome ribs, and the addition of a semi-circular forecourt before the main entrances.

Extensive interior remodeling included reconstruction of the entire inner dome, acoustical refinement, creation of a new projection booth, improving access for the handi-

capped, redecorating of all interior surfaces, and the upgrading of all electrical and mechanical systems and the installation of air conditioning. The 1750-seat facility has new and refurbished seating with pull-up desks, a new and larger sound and lighting system, new stage rigging, and a new central chandelier incorporating spotlights and laser lighting to improve overall visibility and enhance stage productions. A photomural, installed in the lobby, chronicles student life at Illinois and the campus environment of past years.

The rehabilitation of Foellinger Auditorium has forged a link between the past and present, and strengthens in a significant way the University's commitment to the future.





Helene R. Foellinger  
Class of 1932

Her generous gifts made possible  
the expansion and renewal  
of this auditorium.

For her extraordinary dedication  
to the ideals of the University of Illinois  
and for her devotion to excellence  
in higher education, the University  
will ever be grateful.

Originally Dedicated  
November 4, 1907

Rededicated  
Foellinger Auditorium  
April 26, 1985

*Commemorative  
plaque unveiled on  
the forecourt of  
Foellinger Auditorium  
during rededication  
ceremonies.*