

C
ILGW EW
1939

University of Illinois

Statistical and Background Information

Third Annual Issue—Corrected Dec. 1, 1939

THE LIBRARY OF THE

DEC 15 1939

Subject	Page
Activities, student	12
Administrative officers	2
Agricultural Experiment station	9
Agricultural extension	6
Alumni association	10
Alumni foundation	11
Bands	12
Buildings, new	7
Buildings, value of	7
Calendar of events	13
Campus map	last page
Chicago, departments at	3
Chicago units, history	8
Christmas holiday	13
Church foundations	12
Citizen, services to	6
Colleges and schools	3
Colors	13
Correspondence courses	6
Counselling, student	11
Courses, number of	5
Dean of men	11
Dean of women	11
Deans of colleges	3
Degrees conferred	5
Directors of schools	3
Dramatic activities	12
Degrees conferred	5
Easter holiday	13
Employment, student	12
Engineering Experiment station	9
Enrollment, computing	4
Enrollment, 1939-40	5
Enrollment, summer, 1939	5
Enrollment, growth of	10
Expenditures and income	7
Extension	6
Extra-curricular activities	12
Extra-mural courses	6
Fees, tuition	12
Finances, university	12
Firsts at Illinois	9
Foundation, U. of I.	11
Foundations, church	12
Fraternities	11
Gifts to university	11
Health service	11
History of university	8
Hospital	11
Housing, student	11
Illinois union	13

Subject	Page
Income and expenditures	7
Instructional staff	4
Inter-Fraternity council	13
Land, value of	7
Library	6
Loans and scholarships	12
Map of campus	last page
Military training	12
Musical organizations	12
New buildings	7
Nickname	13
Officers, university	2
Pan-Hellenic society	13
Personnel bureau	11
Placement services	11
Plant	7
Public relations offices	3
Publications, student	12
Radio station W I L L	6
Religious opportunities	12
Research	9
Residence Group system	13
Residence halls	11
R. O. T. C. brigade	12
Scholarship recognition	12
Scholarships and loans	12
Semester beginnings, endings	13
Services to citizens	6
Sororities	11
Songs	13
Staff, university	4
State surveys	9
Student activities	12
Student, cost to	12
Student counselling	11
Student employment	12
Student health	11
Student housing	11
Student welfare	11
Students, distribution of	4
Symbol	13
Traditions	13
Trustees	2
Urbana, departments at	3
Urbana units, history	8
Vacations	13
Value of plant	7
Visual Aids service	6
W I L L, radio station	6
Woman's league	13
Woman's group system	13

—From—

JOS. F. WRIGHT, Director of Public Information
362 Administration Bldg. (W), Urbana, Illinois
Telephone, Urbana 7-2400

UNIVERSITY OF ILLINOIS

STATISTICAL AND BACKGROUND INFORMATION

THE LIBRARY OF THE

Third annual issue

Corrected Dec. 1, 1939

DEC 15 1939

UNIVERSITY OF ILLINOIS

C O N T E N T S

(Subject)	(page)
Administration	2
Enrollment	4
Services	5
Finances	7
Plant	7
History	8
Alumni	10
Student welfare	11
Student activities	12
Calendar	13
Map of campus	last page

PURPOSE OF THIS FOLDER

Items in this folder have been brought together, summarized, and corrected to date from a large number of sources. The material has been arranged primarily for the reference use of newspaper, publication, and radio workers, and others needing a concise source of information about the University of Illinois. More detailed information can be found in the Annual Register, and in bulletins issued by the Colleges and Schools, by the Dean of Men, and by other officers. The Office of Public Information always is ready to give assistance in obtaining any information.

Jos. F. Wright

Director of Public Information

Ernest L. Stauffer, M.Arch., Assistant Surveying Architect
 Arthur William Cleveland, A.M., High School
 Harrison Edward Cunningham, A.B.,
 Phineas Lawrence Windsor, Ph.D., List.D., Director of Library
 Fred Radford Brown, Colonel, Commandant of R.O.T.C. (1st semester)
 Robert M. Kirkwood, B.S., Colonel, Commandant of R.O.T.C. (2nd semester)
 Joseph Edward Beard, A.M., M.D., Health Officer
 Albert Austin Harding, M.A., Director of Bands
 Wendell Samuel Wilson, B.S., Director of Interscholastic Athletics
 Charles Robert Frederick, M.S., Director of Student Housing
 Robert Hill Brown, Ph.D., Director of University Extension, and
 Acting Director of Summer Session
 Carl Stephens, A.B., Director of Alumni Relations and Records,
 General Secretary of Alumni Association, and Editor "Alumni News"
 Joseph Franklin Wright, A.B., Director of Public Information, and
 Director of radio station W-I-L-L
 The administrative officer of the Chicago Department of
 Edward E. Allen, M.D., Executive Dean of Chicago Colleges

ADMINISTRATION

Board of trustees--The trustees are elected by the people of the state. Their functions are legislative, and not executive. They secure, so far as possible, the needed revenue, and determine the ways it shall be applied. They formulate general policies for the University, but leave the execution of these policies to the administrative officers.

Members of the Board of Trustees are:

Members ex officio.

Henry Horner, Governor of Illinois, Springfield

John A. Wieland, superintendent of public instruction, Springfield
Elected, term 1935-41.

Oscar G. Mayer, 1241 Sedgwick street, Chicago

Mrs. Glenn E. Plumb, 4610 Drexel boulevard, Chicago

Harold A. Pogue, 617 West Decatur street, Decatur
Elected, term 1937-43.

Homer Mat Adams, 302 State Armory, Springfield

James M. Cleary, 310 South Michigan avenue, Chicago

Louis C. Moschel, P. O. Box 146, Pekin
Elected, term 1939-45.

Frank A. Jensen, LaSalle

Orville M. Karraker, 405 Centennial building, Springfield

Dr. Karl A. Meyer, Cook county hospital, Chicago

Officers of the Board of Trustees are:

Oscar G. Mayer, Chicago, President

Harrison E. Cunningham, Urbana, Secretary

Frank M. Gordon, First National bank, Chicago, Treasurer

Lloyd Morey, Urbana, Comptroller

Administrative officers--at Urbana-Champaign are:

Arthur Cutts Willard, B.S., D.Eng., LL.D., President

Albert James Harno, B.S., LL.B., LL.D., Provost

Sveinbjorn Johnson, A.M., LL.B., LL.D., Counsel

Lloyd Morey, A.B., B.Mus., LL.D., C.P.A., Comptroller

George Philip Tuttle, B.S., Registrar

Fred Harold Turner, Ph.D., Dean of Men

Maria Leonard, A.M., Litt.D., Dean of Women

Charles Stewart Havens, M.S., Director of Physical Plant

Ernest L. Stouffer, M.Arch., Assistant Supervising Architect

Arthur Wilbur Clevenger, A.M., High School Visitor

Harrison Edward Cunningham, A.B., Director of University Press

Phineas Lawrence Windsor, Ph.B., Litt.D., Director of Library

Fred Radford Brown, colonel, Commandant of R.O.T.C. (1st semester)

Robert G. Kirkwood, B.S., colonel, Commandant of R.O.T.C. (2nd semester)

Joseph Howard Beard, A.M., M.D., Health Officer

Albert Austin Harding, Mus.D., Director of Bands

Wendell Samuel Wilson, B.S., Director of Intercollegiate Athletics

Charles Robert Frederick, M.S., Director of Student Housing

Robert Bell Browne, Ph.D., Director of University Extension, and

Acting Director of Summer Session

Carl Stephens, A.B., Director of Alumni Relations and Records,

General Secretary of Alumni Association, and Editor "Alumni News"

Josef Franklin Wright, A.B., Director of Public Information, and

director of radio station W-I-L-L

The administrative officer of the Chicago departments is:

Raymond B. Allen, H.D., Executive Dean of Chicago Colleges

Heads of colleges and schools--The University is composed of 15 colleges and schools. Deans head the Colleges; Directors the Schools. Three of the Colleges are located in Chicago. The other Colleges and the Schools are at Urbana-Champaign.

The units, their heads, and offices are:

- Agriculture, College of, Henry Perly Rusk, M.S., Dean, and director of Agricultural Experiment Station and Extension service, 101 New Agriculture building, Urbana
- Commerce, College of, Charles Manfred Thompson, Ph.D., LL.D., Litt.D., Dean, and Director of Bureau of Business Research, 213 Commerce building, Urbana
- Dentistry, College of, Frederick Bogue Noyes, A.B., DD.S., D.Sc., LL.D., Dean, 808 South Wood street, Chicago
- Education, College of, Thomas Eliot Benner, Ed.D., Dean, 104 Administration building (East), Urbana
- Engineering, College of, Melvin Lorenus Enger, M.S., C.E., Dean, and Director of Engineering Experiment Station, 106 Engineering hall, Urbana
- Fine and Applied Arts, College of, Rexford Newcomb, A.M., M.Arch., Dean, and Director of Bureau of Community Planning, 110 Architecture building, Urbana
- Graduate School, Robert Daniel Carmichael, Ph.D., Dean, 109 Administration building (East), Urbana
- Journalism, School of, Lawrence William Murphy, A.M., Litt.D., Director, 101 Commerce building, Urbana
- Law, College of, Albert James Harno, B.S., LL.B., LL.D., Dean, 301 Law building, Urbana
- Liberal Arts and Sciences, College of, Matthew Thompson McClure, Ph.D., Litt.D., Dean, 203 Lincoln hall, Urbana
- Library School, Phineas Lawrence Windsor, Ph.B., Litt.D., Director, 222 Library building, Urbana
- Medicine, College of, David John Davis, M.D., Ph.D., Dean, 1853 West Polk street, Chicago
- Music, School of, Frederic B. Stiven, Mus.D., Director, 100 Smith Music hall, Urbana
- Pharmacy, College of, Albert Henry Clark, Ph.G., M.S., Acting Dean, 1853 West Polk street, Chicago
- Physical Education, School of, Seward Charle Staley, Ph.D., Director, 107 George Huff gymnasium, Urbana

Public relations offices--Public relations and information activities at the University may be divided into three branches. First is general University public information carried on by the Public Information office. Second are the specialized activities of the Athletic association, Agricultural Extension, Alumni Association, and Alumni Foundation. Third are the State Surveys affiliated with the University.

The offices are:

- Public Information office, Josef F. Wright, Director, Frank E. Schooley, Assistant Director, 362 Administration building (West), Urbana, Ill.; telephone, Urbana 7-2400
- Athletic association, Louis M. Tobin, Director of Publicity, 110 George Huff gymnasium, Champaign, Ill.; telephone, Champaign 5261
- Agricultural and Home Economics Extension, Frederick J. Keilholz, Extension Editor, 109 New Agriculture building, Urbana, Ill.; telephone, Urbana 7-2680
- Alumni association, Carl Stephens, General Secretary and Editor "Alumni News" (monthly magazine), 118 Student Center building, Champaign, Ill.; telephone, Champaign 4109.

University of Illinois Foundation, James C. Colvin, Secretary and Editor "Illini News," 334 Student Center building, Champaign, Ill.; telephone, Champaign 2662

Illinois State Geological Survey, Don L. Carroll, Associate Geologist, 305 Ceramics building, Urbana, Illinois; telephone, Urbana 7-1138

Illinois State Natural History Survey, James S. Ayars, Editor, 101 Entomology building, Urbana, Ill.; telephone, Urbana 7-4226

University Staff -- Dec. 1, 1939:

Administration (excluding 61 counted under instruction)		
Urbana-Champaign departments	47	
Chicago departments	9	
Total, administration		56
Instruction		
Urbana-Champaign departments	1146	
Chicago departments (including 329 non-salaried)	572	
Total, instruction		1718
Research (experiment stations, research bureaus, etc.)		
Urbana-Champaign departments	295	
Deduct duplicates (persons also under instruction)	-117	
Net total, research		178
Librarians		
Urbana-Champaign departments	93	
Chicago departments	3	
Total, librarians		96
Extension		
Agriculture and home economics	71	
University extension (correspondence courses, etc.)	4	
Deduct duplicates (also research or instruction)	-14	
Net total, extension		61
Miscellaneous (clerks, technicians, etc., but not laborers)		
Urbana-Champaign departments	351	
Chicago departments	157	
Total, miscellaneous		508
Retired (formerly in groups listed above)		
Urbana-Champaign departments	49	
Chicago departments	21	
Total, retired		70
Total, Urbana-Champaign departments	1925	
Total, Chicago departments	762	
Grand total		2687

ENROLLMENT

Methods of computing--Confusion sometimes results from the various ways in which enrollment may be computed. One computation is the number of different individuals, exclusive of correspondence students, enrolled during one entire academic year. This includes two winter semesters and the preceding summer session. For the 1938-39 year (including 1938 summer), this total was 17,500 individuals. Some of these were at the University through both semesters and the summer, others only during the winter semesters, only during the summer, or only during one semester. For details of total individuals enrolled during the 1938-39 academic year see last column of the table on page 10. A second enrollment computation is the first semester enrollment which is the greatest number of persons on the campus at one time. (See next page.) About 87 per cent of the students are Illinois residents.

Enrollment, first semester, 1939-40:

	Men	Women	Total
Urbana-Champaign			
Undergraduate and professional students	7,978	3,027	11,005
Graduate students	1,018	267	1,285
Total, Urbana-Champaign	8,996	3,294	12,290
Chicago			
Undergraduate students	1,033	81	1,114
Graduate students	147	26	173
Less duplicates	-56	-11	-67
Total, Chicago	1,124	96	1,220
Extra-mural courses	273	111	384
Total enrollment, first semester	10,393	3,501	13,894

Enrollment, summer session, 1939:

	Men	Women	Total
Urbana-Champaign			
Undergraduate and professional students	1,025	1,049	2,074
Graduate students	1,098	514	1,612
Total, Urbana-Champaign	2,123	1,563	3,686
Chicago			
Undergraduate students	107	3	110
Graduate students	84	14	98
Total, Chicago	191	17	208
Total enrollment, summer, 1939	2,314	1,580	3,894

SERVICES

Courses--Each semester approximately 1,850 courses are offered in the Urbana-Champaign and Chicago departments. Many of these courses have numerous sections because of the large enrollment. The total number of sections each semester is about 4,000. There are 107 sections of the freshman rhetoric course alone.

Degrees conferred:

	(1936)	(1937)	(1938)	(1939)
Bachelors degrees				
Urbana-Champaign departments (agriculture, architecture, art, commerce, education, engineering, floriculture, home economics, journalism, law, landscape architecture, liberal arts and sciences, library science, music, physical education)	1811	1953	2185	2344
Chicago departments (dentistry, medicine, pharmacy)	189	224	206	218
Masters degrees				
Urbana-Champaign departments	390	485	507	597
Chicago departments	22	20	24	38
Doctor of philosophy				
Urbana-Champaign departments	90	106	114	110
Chicago departments	4	5	6	2
Doctor of medicine (Chicago)	123	143	148	159
Doctor of dental surgery (Chicago)	24	23	42	40
Professional engineering degrees (Urbana)	8	6	7	8
Total conferred at Urbana	2299	2550	2813	3059
Total conferred at Chicago	362	415	428	457
Total degrees conferred	2661	2965	3239	3516

Extension--The Division of University Extension maintains correspondence courses, extra-mural courses, the Visual Aids service, and the Speech Aids service. Eighty-six college-level courses are offered by mail. Total enrollment in a year is about 1,200. Credit towards a University degree is allowed. Twelve extra-mural classes are being taught this year in as many Illinois cities by University faculty members who go to their classes each week. The Visual Aids service provides 300 schools with 20,000 film subjects. Its films were seen during the past year by audiences totaling approximately 1,250,000.

Agricultural extension--The extension service in agriculture and home economics is carried on through the College of Agriculture. It has some 71 specialists in these fields, including 4-H club work. They maintain contact with 97 farm advisers serving 102 counties, and 63 home advisers serving 69 counties.

Radio station WILL--The only state-owned, non-commercial, educational radio station in Illinois is that of the University, WILL. It operates daily, except Sunday, from 7 a.m. to local sunset. Its frequency is 580 kilocycles. Power of 5,000 watts enables this station to be heard by listeners in most parts of Illinois and in nearby areas of adjacent states.

Library--Illinois has the largest of all state university libraries, and the fifth largest American university library. There are about 1,117,000 volumes, 320,000 pamphlets, 3,900 maps, and 10,600 pieces of sheet music in the main library and 16 departmental libraries at Urbana-Champaign; and about 58,000 volumes and 10,000 pamphlets in the departments at Chicago. More than 30,000 volumes are added each year. The recorded use by students and faculty exceeds 1,000,000 calls a year.

Research--See page 9.

Services direct to citizens--1938-39

		(Individuals served)
Students enrolled		
Urbana-Champaign campus, including summer	15,713	
Chicago campus	1,311	
Extra-mural courses	426	
Correspondence courses	1,200	18,700
Attendance at meetings on the campus		
Urbana, more than 65 large meetings	52,000	
Chicago	3,000	55,000
Agriculture visitors, not attending large meetings		20,000
Patients at medical and dental clinics in Chicago		100,000
Attendance at athletic events		
Varsity, high school finals, exhibitions	297,700	
Less duplicates, repeat student attendance	-121,700	
Net individuals attending athletic events		176,000
Attendance at meetings off the campus	50,000	
Agricultural extension, 25,000 meetings	1,250,000	
Speakers bureau	25,000	
Illinois Speech league	2,700	
Visual Aids service, total audiences	1,250,000	
Total attendance	2,514,000	
Individuals attending, duplications subtracted		603,000

Bulletins and other publications (copies)	
Agricultural experiment station.....	838,000
Engineering Experiment station.....	32,000
Special research bureaus.....	5,000
University catalogues and special pamphlets.....	55,000
Monographs, theses, etc.....	8,000
Total copies sent out.....	938,000
Individuals sent to, duplications subtracted.....	300,000
Less duplicates among items, students at events.....	-37,000
Approximate net total, persons directly served.....	1,235,700

In addition, thousands of other persons visit the campus annually; and an unknown number hear the University's radio station, WILL.

FINANCES

For 1939-40 the University operating budget is \$8,532,397. This includes \$5,432,500 from tax revenues through the biennial state appropriation, plus income from other sources. Exact amounts are not known until all income from student fees, etc., has been received at the end of the fiscal year. Details of the last fiscal year's income, 1938-39, are:

Income (1938-39)		Disbursements (1938-39)	
Taxation.....	63.4%	Instruction.....	53.3%
Student fees.....	16.7%	Organized research.....	13.2%
Federal government.....	11.6%	Plant operation.....	14.4%
Gifts and endowments.....	3.8%	Agricultural extension.....	7.5%
Miscellaneous.....	4.5%	Administration and general.....	6.5%
		Libraries.....	5.1%

PLANT

The University physical plant--land, buildings, and equipment--is valued at nearly \$31,892,000. It is located principally at Urbana-Champaign, but includes also land and buildings in Chicago for the departments there, and experimental lands of the College of Agriculture which are located in other parts of the state.

Details as of June 30, 1939 are:

Land, 2,318 acres, Urbana-Champaign, Chicago, etc.....	\$ 1,648,811
Buildings, 77 major, 35 minor, 23 houses.....	19,266,042
Uncompleted buildings.....	207,369
Other improvements, lights, sidewalks, etc.....	1,516,179
Library, books and equipment.....	3,020,803
Movable equipment.....	5,535,911
Equity in Medical and Dental building at Chicago.....	509,638
Equity in Illini Student Union building.....	159,975
Equity in University of Illinois Union, Inc., property.....	27,253
Total value, University of Illinois plant.....	\$31,891,981

New buildings--Under construction are the Illini Union building; Gregory hall, a classroom structure to replace 65-year old University hall, which was condemned and razed in 1938; and the Natural Resources building to house the state surveys affiliated with the University. Almost completed are additions to the Library for more bookstack space, and to McKinley student

hospital for 45 additional beds. Contracts have been let for two other buildings, a Power Plant to replace a present inadequate plant and to care for increased load, and an Applied Research laboratory for the state Geological survey. Plans are being prepared for a three-unit men's residence hall to house 300 students. This is to be ready in September, 1941.

Estimated costs of new buildings are:

Illini Union building	\$1,400,000
Gregory hall	874,000
Library addition	225,000
McKinley hospital addition	181,000
Natural Resources building	545,500
Applied Research laboratory	95,000
Power plant	1,675,000
Men's residence hall units	600,000
Total, building projects	\$5,595,500

HISTORY

The University of Illinois was chartered February 28, 1867, by the state general assembly as the Illinois Industrial university. It has the distinction of being the land grant college of the state in which the land grant college movement originated in 1851; the state which was the home of President Abraham Lincoln who signed the land grant college act in 1862. The University opened March 2, 1868, with 50 students and three faculty members. Women were admitted in 1870. In 1885 the name was changed to University of Illinois.

Urbana-Champaign departments--From the beginning, instruction was offered in agriculture, engineering, and the liberal arts and sciences. Graduate work was organized in 1892. Summer sessions were started in 1894. Studies in law were organized as a school in 1896, and as a college in 1900. The School of Music was organized in 1897, and now is a part of the College of Fine and Applied Arts, which was organized in 1931. In 1897 the Library school was formed by the acquisition of the School of Library Economy which had been organized in 1893 at the Armour Institute in Chicago. Business training was started in 1900, and organized into the College of Commerce in 1915. Journalism instruction was begun in 1902, and the School of Journalism organized in 1927. The School of Education was organized in 1905, and became a college in 1918. The School of Physical Education was organized in 1932.

Chicago departments--The School of Pharmacy was organized in 1896 by the acquisition of the Chicago College of Pharmacy, founded in 1859, and in 1932 became the College of Pharmacy. In 1897 the College of Physicians and Surgeons of Chicago, established in 1881, became affiliated with the University of Illinois, and in 1913 became the College of Medicine. The College of Dentistry was formed in 1905 from a department created in 1901 in the College of Medicine.

Research—The University of Illinois is internationally known for its research accomplishments. Agricultural research was begun at an early date, and the Agricultural Experiment station was organized in 1898. The oldest soil experiment plots in America, the Morrow plots first planted in 1876, are on the Urbana-Champaign campus. The Engineering Experiment station, first in America, was established in 1903; the Bureau of Educational Research in 1918; Bureau of Business Research in 1921; Bureau of Community Planning in 1934. The headquarters of the Illinois State Natural History survey, State Water survey, and State Geological survey are located on the campus at Urbana-Champaign.

Research that is paying a definite return is worth millions of dollars annually to the state and nation. Outstanding investigations have been made and are being carried on in agriculture, engineering, chemistry, medicine, and many other fields. Of every operating dollar, about 13 cents is spent directly for organized research. In addition, many investigations are financed in whole or in large part by individuals and groups (including industrial and commercial organizations), and the results are published by the University for the benefit of everyone.

First at Illinois:

- First pharmacy school west of Alleghanies, 1859
 - First architectural instruction west of Alleghanies, 1868
 - First shop for engineering education in America, 1870
 - First evidence of bacteria causing plant disease, by T.J. Burrill, 1871
 - First architecture graduate in America, Clifford Ricker, 1872
 - First soil experimental plots in America, continuous use since 1876
 - First library school west of Alleghanies, 1893
 - First interscholastic track and field meet in Middle West, 1893
 - First dean of women, Miss Violet D. Jayne, 1897
 - First dean of men, Thomas Arkle Clark, 1901
 - First cheer leader, R. C. Matthews, 1902
 - First engineering experiment station, 1903
 - First railway engineering department, now only in nation, 1906
 - First collegiate Homecoming celebration, 1910
 - First church foundation at any campus, Wesley foundation, 1913
 - First super-sensitive photoelectric cell, by Jakob Kunz, 1913
 - First summer courses for athletic coaches, 1914
 - First indoor intercollegiate relay carnival, 1917
 - First four-year athletic coaching course, 1919
 - First alkali-vapor radio tubes, by Hugh A. Brown, 1920
 - First collegiate Dad's day celebration, 1920
 - First sound-on-film sound movies, by J. T. Tykociner, 1921
 - First official university Mother's day celebration, 1921
 - First student newspaper to have full AP wire service, 1923
 - First short course for firemen, 1925
 - First Boy Scout day at football game, 1925
 - First Ph.D. granted in accountancy, J. W. McMahan, 1939
- Pioneer work in reinforced concrete, bridge design, materials testing, air conditioning, electronics.
- Pioneer work in dairy cattle improvement, corn breeding, improved methods of feeding beef cattle, control of animal diseases, agricultural adjustment, farm accounting, and farm records.

Attendance, total of year opening each decade: ⁴
 (For relation to enrollment statistics see page ⁵)

College or School	1868	1873	1889*	1898	1908	1918	1928	1938	1939**
Agriculture	a	19	6	23	486	657	668	1455	1598
Engineering	a	55	140	a	1187	916	1768	1775	1857
Liberal Arts & Sciences	a	154	117	696	982	1738	4497	4065	4104
Library				a	45	53	89	99	110
Education					a	a	1033b	549	582
Music					72	113	135	d	...
Commerce						606	1929	2402	2116
Journalism							52c	203	169
Fine & Applied Arts								713e	739
Physical Education								403f	423
Law				39	186	46	398	282	303
Graduate		10	4	78	203	375	859	1368	1452
Miscellaneous		48	30						
Preparatory (Academy)		118	121	199	377	g			
Summer session***					367	833	2179	3345	3704
Total at Urbana	77	404	418	1035	3946	5007	12725	15346	15713
Medicine				408	476	263	486	648	644
Dentistry					76	173	193	202	223
Pharmacy				140	259	147	629	230	247
Graduate work in medicine & dentistry							30	183	212
Summer work in medicine & dentistry***							75	136	193
Total at Chicago				548	811	583	1346	1299	1361
Extra-mural courses								220	426
GRAND TOTAL	77	404	418	1582	4743	5590	14071	16865	17500

a Not separated

b Education enrollment previously under Liberal Arts and Sciences

c Journalism enrollment previously under Liberal Arts and Sciences

d Absorbed in College of Fine and Applied Arts

e Fine and Applied Arts enrollment previously under Music, Engineering, Liberal Arts and Sciences, and Agriculture

f Physical Education enrollment previously under Education

g Discontinued; work carried on by University high school

* No breakdown for 1888 available; total enrollment 377

** Latest complete year, 1938-39

*** Summer session duplicates, students attending both winter session and summer session, subtracted in totals for years. Summer session opens school year, consequently summer of 1907 opens 1907-08 year and is included in 1908 total, etc.; 1938 summer is that included for 1939.

(For first semester, 1939-40, see page 5)

(For 1938 summer session, see page 5)

ALUMNI

Alumni Association--The University of Illinois Alumni association was founded in 1873. Current officers are: Charles H. Thompson '09, Champaign, president; Irene D. Pierson '25, Urbana, first vice-president; Waldo Ames '17, Chicago, second vice-president; Charles Wham '12, Centralia, immediate past president; Carl Stephens '12, Urbana, general secretary and editor of "Alumni News;" Gleyn Goodwine '23, Urbana, treasurer. Living alumni and former students of the University total some 130,000, of whom 71,000 are living in the state of Illinois.

Alumni Foundation--The University of Illinois Foundation was established in 1935 to encourage gifts to the University. It is sponsoring the new \$1,400,000 Illini Union building. Officers of the foundation are: Charles M. Thompson, Champaign, president; Charles S. Pillsbury, Chicago, vice-president; James C. Colvin, Urbana, secretary. Principal alumni gift to the University previous to establishment of the foundation was the \$2,000,000 Memorial stadium, dedicated in 1924 to former students killed in the World war. Each graduating class also has left a gift. Several classes together gave the famous "Alma Mater" statuary group by Lorado Taft (an Illinois graduate in 1879), the chimes in the Law building tower, and other memorials.

STUDENT WELFARE

Counselling--For personal counselling, the Dean of Men and Dean of Women and their staffs are advisors of first resort for students with problems. They also are a last resort for individual problems unsolved by other agencies. The Personnel Bureau in the College of Liberal Arts and Sciences deals with scholastic, vocational, and personal problems through application of psychological methods and tests by trained workers. The results are interpreted to the individuals by counsellors who are selected faculty members in close contact with student life and affairs. Advice of the Bureau is available to all students and also to prospective students. The deans of the colleges and directors of the schools also advise students and prospective students. Placement service for graduates is carried on by the colleges and schools, supplemented by the offices of the Dean of Men and Dean of Women.

Health--A physical examination by the University Health Service is required of new students. The Health Service physicians are available to students for advice or consultation. They also teach courses in elementary hygiene and sanitation which are required of all freshmen. A fully equipped hospital is maintained at Urbana-Champaign by the University. (The College of Medicine is at Chicago.) Because most students when ill would not receive the care in their campus living quarters that they would if at home, they are urged to utilize the hospital. Expense of hospital care is met in many cases through voluntary membership in a mutual-benefit hospital association, founded in 1898, which has 6,000 student and faculty members at present.

Housing--Living conditions and off-campus activities of students are supervised by the Division of Student Housing created in 1939. One third of the women students live in 24 sororities; 350 in three University women's residence halls; 50 in three University co-operative houses; the remaining women live in private homes under University regulations. One-third of the men students live in 62 fraternities. At present the University has only one small residence unit for men, but plans are being prepared for a three-unit structure to house 300 men after September, 1941. Privately operated dormitories and rooming houses for men are inspected and approved by the University.

Costs--Student budgets at the Urbana-Champaign campus vary from \$500 or \$600 per year to \$800 or more. This includes incidental (tuition) fees of \$70 a year for Illinois residents or \$125 a year for out-of-state students. Costs for students enrolled in the colleges located in Chicago are higher.

Employment--More than one-third of the students at Urbana-Champaign earn a part of their expenses while attending the University. A few earn almost all. Room and board jobs make up about half the work available. The other half is of many kinds. The University maintains an employment bureau for arranging part-time employment for students. No charge is made for this service, which includes both temporary and year-around jobs. This bureau also has charge of student employment under the National Youth administration, which provides federal funds to aid a limited number of specially needy students. The assignment of NYA jobs, the number of students hired, and the rate of pay are governed by federal regulations.

Loans and scholarships--Student loans, temporary or long-term, are arranged through the dean of men or dean of women. Funds for this purpose have been provided by gifts of various groups and individuals. A large number of scholarships are granted regularly through competitive examinations or selections.

STUDENT ACTIVITIES

Scholarship--Each spring an Honors day convocation is held to recognize the leading students. All leading national honorary organizations have chapters at the University. Two national honorary organizations to encourage high scholarship among freshmen, Phi Eta Sigma for men, Alpha Lambda Delta for women, were founded at Illinois and now have chapters throughout the nation. Recognition is given annually to fraternities, sororities, and independent groups ranking high in scholarship.

Military training--Two years of military training are required of undergraduate men except those specially exempted. The University's R.O.T.C. brigade is one of the largest in the nation. Present enrollment is 3,988, exclusive of University bands. Of this enrollment, 563 men are in the optional two-year advanced work leading to a commission as second lieutenant in the U.S. army reserve. Units comprising the Illinois R.O.T.C. brigade are: infantry, cavalry, field artillery, coast artillery, engineers, signal corps.

Religious opportunities--Although the University of Illinois is non-sectarian, various religious groups have established Foundations or "church homes away from home" adjacent to the campus. The church foundation idea originated at Urbana in 1913 when the Wesley Foundation was established. Now there are nine religious Foundations near the University campus; three other churches in Urbana-Champaign are attended chiefly by students and faculty members. A \$300,000 Y.M.C.A. building was dedicated in 1938. The Y.W.C.A. also has a large building adjacent to the campus.

Extra-curricular activities--Student publications include the "Daily Illini," full-size morning newspaper with Associated Press leased wire service and \$90,000 plant; the "Illio," a huge yearbook; and several specialized publications. University of Illinois Bands have received the highest praise of such men as John Philip Sousa, Edwin Franko Goldman, and Frank Simons. Other musical organizations are a Chorus, Concert Orchestra, Men's Glee Club, and

Women's Glee Club. The Illini Theatre Guild presents many productions each year. The Broadcasters present drama and other radio activity over the University's radio station, WILL. Some 275 specialized social, scholastic, religious, and honorary organizations embrace practically every field of endeavor and interest.

All men are members of the Illinois Union. Fraternity members are united in the Inter-Fraternity Council. The Men's Independent District Association embraces all non-fraternity men. All women are members of Woman's League, which is composed of Pan-Hellenic society comprising all sororities, Residence Group system comprising the women's residence halls and co-operative houses, and Women's Group system comprising groups embracing all other undergraduate women.

Traditions--University of Illinois colors are orange and blue; nickname, Illini, pronounced "ill-eye'-nigh"; symbol, Indian; most famous songs, "Illinois Loyalty" and "Hail to the Orange."

1939

CALENDAR

- Dec. 8 Junior Prom at Urbana-Champaign
 16 Holiday vacation begins at Chicago, 5 p.m.
 20 Holiday vacation begins at Urbana-Champaign, 8 a.m.
- 1940
- Jan. 2 Holiday vacation ends at Chicago, 8 a.m.
 3 Holiday vacation ends at Urbana-Champaign, 8 a.m.
 12 Sophomore Cotillion at Urbana-Champaign (tentative)
 13 Freshman Frolic at Urbana-Champaign (tentative)
 30 First semester ends at Urbana-Champaign
- Feb. 3 First semester ends at Chicago
 2-6 Registration at Urbana-Champaign
 5 Registration at Chicago
- Mar. 2 University day; first classes met Mar. 2, 1868
 21 Easter vacation begins at Chicago, 6 p.m.
 22 Easter vacation begins at Urbana-Champaign, 8 a.m.
 25 Easter vacation ends at Chicago, 8 a.m.
 26 Easter vacation ends at Urbana-Champaign 8 a.m.
 29-30 Electrical engineering show at Urbana-Champaign (tentative)
- May 3 Honors day convocation at Urbana-Champaign
 23 Military day, R.O.T.C. brigade review, at Urbana-Champaign
- June 3 Second semester ends at Urbana-Champaign
 3 Senior Ball at Urbana-Champaign
 6 Class day at Chicago
 7 Commencement at Chicago
 8 Alumni-Class day at Urbana-Champaign
 9 Baccalaureate service at Urbana-Champaign
 10 Sixty-ninth annual Commencement at Urbana-Champaign
 17 Summer session registration at Urbana-Champaign
- Aug. 10 Summer session closes at Urbana-Champaign
- Sept. 13-17 Registration for first semester, 1940-41, at Urbana-Champaign
 23 Registration for first semester, 1940-41, at Chicago

KEY TO LOCATION OF BUILDINGS

Combinations of Numbers and Letters Following the Names of Buildings Refer to Blocks from West to East and from North to South, Respectively, As Indicated by the Numbers and Letters in the Margin of the Map.

- | | |
|---------------------------------------|--|
| Administration Building 7-G | Library 7-J |
| Agriculture Building (old) 8-H | Lincoln Hall 7-H |
| Agriculture Building, New 8-K | Locomotive Testing Laboratory 9-D |
| Agricultural Engineering Building 8-L | McKinley Hospital 12-L |
| Agronomy Greenhouse 8-I | Machine Laboratory 7-D |
| Animal Pathology Laboratory 6-L | Mathematics Building 7-G |
| Architecture Building 8-K | Mechanical Engineering Laboratory 8-E |
| Armory 4-J | Memorial Stadium 2-N |
| Auditorium 7-I | Men's Gymnasium (old building) 7-C |
| Band Building 5-J | Men's New Gymnasium 4-K |
| Botany Greenhouse 9-D | Military Barns 4-M |
| Busby Hall 10-I | Mining Laboratory 9-D |
| Ceramics Building 9-D | Music Hall, Smith Memorial 8-I |
| Ceramics Laboratory 9-D | Natural History Building 8-F |
| Chemistry Annex 8-H | Natural Resources Building 6-M |
| Chemistry Building 8-G | New Agriculture Building 8-K |
| Commerce Building 7-K | New Gymnasium, Men's 4-K |
| Dairy Manufactures Building 8-M | North Greenhouse 7-E |
| Davenport House 6-G | Observatory 8-J |
| Education Building (U.H.S.) 9-C | Physics Laboratory 8-E |
| Electrical Engineering Laboratory 7-E | Physiological Psychology Laboratory 10-D |
| Electrical Engineering Annex 8-E | Power Plant 8-D |
| Engine Annex 7-C | Radio Station (WILL) 7-C |
| Engineering Hall 8-E | Smith Memorial Music Hall 8-I |
| Entomology Building 8-F | South Garage 9-L |
| Evans Hall 10-I | Stadium, Memorial 2-N |
| Experimental Zoology Laboratory 6-D | State Entomologist's Laboratory 8-I |
| Filtration Plant 8-D | State Geological Survey Laboratory 9-E |
| Fireman's Training Tower 6-D | Stock Pavilion 7-M |
| Floriculture Greenhouses 10-K | Storage Building 9-L |
| Garage and Shops 10-D | Storeroom and Warehouse 10-D |
| Genetics Building 8-L | Surveying Building 6-K |
| Gregory Hall 7-I | Talbot Laboratory 7-D |
| Grounds Department Barns 5-M | Theatre Guild Studio 9-E |
| Gymnasium Annex 7-C | Tractor Laboratory 9-L |
| Gymnasium, Men's (old building) 7-C | Transportation Building 9-D |
| Gymnasium, Men's New 4-K | University High School (Education) 9-C |
| Gymnasium, Woman's 10-J | University High School Gymnasium 9-C |
| Health Service Building 7-E | Vegetable Greenhouses 10-K |
| Ice Skating Rink 4-I | Woman's Building 7-H |
| Illini Union 7-F | Woman's Gymnasium 10-J |
| Law Building 7-F | Wood Shop and Foundry 7-D |

UNIVERSITY OF ILLINOIS CAMPUS

1939

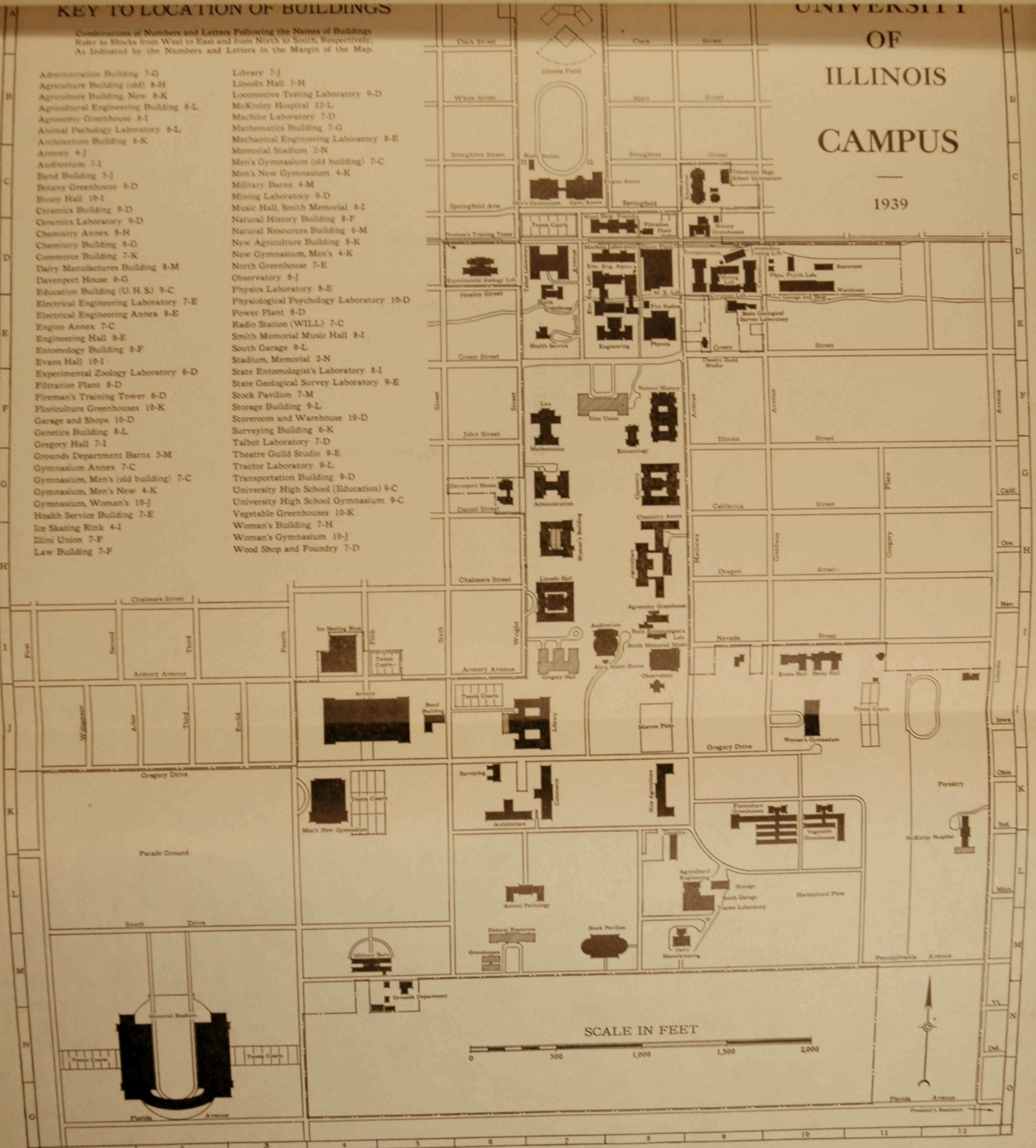

KEY TO LOCATION OF BUILDINGS

Combinations of Numbers and Letters Following the Names of Buildings Refer to Blocks from West to East and from North to South, Respectively, As Indicated by the Numbers and Letters in the Margin of the Map.

- | | |
|---------------------------------------|--|
| Administration Building 7-G | Library 7-J |
| Agriculture Building (old) 8-H | Lincoln Hall 7-H |
| Agriculture Building, New 8-K | Locomotive Testing Laboratory 9-D |
| Agricultural Engineering Building 8-L | McKinley Hospital 12-L |
| Agronomy Greenhouse 8-I | Machine Laboratory 7-D |
| Animal Pathology Laboratory 6-L | Mathematics Building 7-G |
| Architecture Building 6-K | Mechanical Engineering Laboratory 8-E |
| Armory 4-J | Memorial Stadium 2-N |
| Auditorium 7-I | Men's Gymnasium (old building) 7-C |
| Band Building 5-J | Men's New Gymnasium 4-K |
| Botany Greenhouse 9-D | Military Barns 4-M |
| Busey Hall 10-I | Mining Laboratory 9-D |
| Ceramics Building 9-D | Music Hall, Smith Memorial 8-I |
| Ceramics Laboratory 9-D | Natural History Building 8-F |
| Chemistry Annex 8-H | Natural Resources Building 6-M |
| Chemistry Building 8-G | New Agriculture Building 8-K |
| Commerce Building 7-K | New Gymnasium, Men's 4-K |
| Dairy Manufactures Building 8-M | North Greenhouse 7-E |
| Davenport House 6-G | Observatory 8-J |
| Education Building (U. H. S.) 9-C | Physics Laboratory 8-E |
| Electrical Engineering Laboratory 7-E | Physiological Psychology Laboratory 10-D |
| Electrical Engineering Annex 8-E | Power Plant 8-D |
| Engine Annex 7-C | Radio Station (WILL) 7-C |
| Engineering Hall 8-E | Smith Memorial Music Hall 8-I |
| Entomology Building 8-F | South Garage 9-L |
| Evans Hall 10-I | Stadium, Memorial 2-N |
| Experimental Zoology Laboratory 6-D | State Entomologist's Laboratory 8-I |
| Filtration Plant 8-D | State Geological Survey Laboratory 9-E |
| Fireman's Training Tower 6-D | Stock Pavilion 7-M |
| Floriculture Greenhouses 10-K | Storage Building 9-L |
| Garage and Shops 10-D | Storeroom and Warehouse 10-D |
| Genetics Building 8-L | Surveying Building 6-K |
| Gregory Hall 7-I | Talbot Laboratory 7-D |
| Grounds Department Barns 5-M | Theatre Guild Studio 9-E |
| Gymnasium Annex 7-C | Tractor Laboratory 9-L |
| Gymnasium, Men's (old building) 7-C | Transportation Building 9-D |
| Gymnasium, Men's New 4-K | University High School (Education) 9-C |
| Gymnasium, Woman's 10-J | University High School Gymnasium 9-C |
| Health Service Building 7-E | Vegetable Greenhouses 10-K |
| Ice Skating Rink 4-I | Woman's Building 7-H |
| Illini Union 7-F | Woman's Gymnasium 10-J |
| Law Building 7-F | Wood Shop and Foundry 7-D |

UNIVERSITY OF ILLINOIS CAMPUS

1939



Gregory Hall 7-I
 Grounds Department Barns 5-M
 Gymnasium Annex 7-C
 Gymnasium, Men's (old building) 7-C
 Gymnasium, Men's New 4-K
 Gymnasium, Woman's 10-J
 Health Service Building 7-E
 Ice Skating Rink 4-I
 Illini Union 7-F
 Law Building 7-F

Talbot Laboratory 7-D
 Theatre Guild Studio 9-E
 Tractor Laboratory 9-L
 Transportation Building 9-D
 University High School (Education) 9-C
 University High School Gymnasium 9-C
 Vegetable Greenhouses 10-K
 Woman's Building 7-H
 Woman's Gymnasium 10-J
 Wood Shop and Foundry 7-D

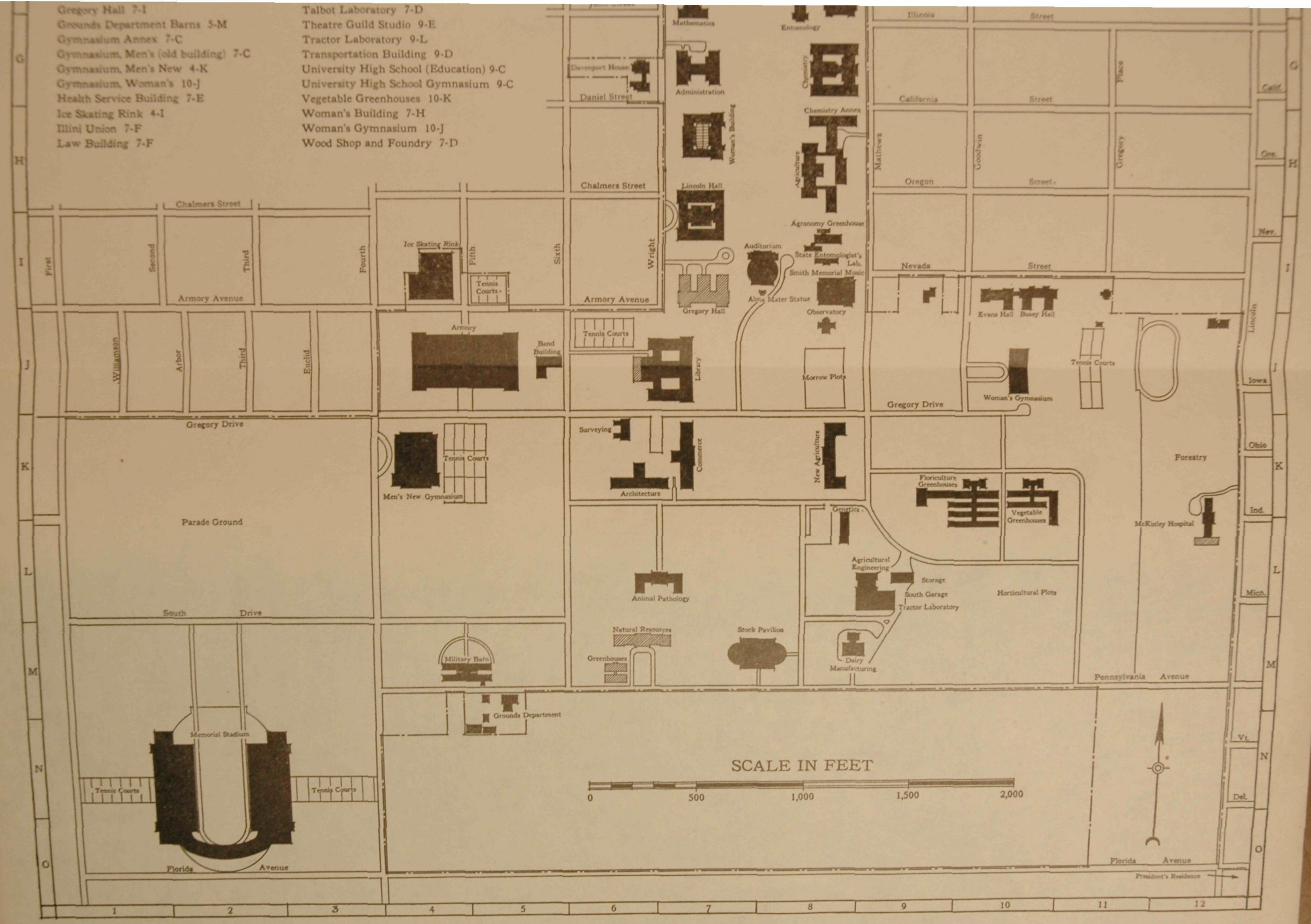

SCALE IN FEET

